

Lollipop Stand - LOLPOP Series

The stand consists of 3 main parts, a top half circle, a round upright, and a round base.

1. Place the base on the floor with aluminum base bushing pointed up. Slide the round upright over the base bushing. Align the hole in the upright with the hole in the base bushing. Use the short screw provided and screw through the upright into the base bushing, and fully tighten (don't over tighten).
2. Place the round washer on top of the upright, with the flat side up. Place the thread from the top half circle through the washer into the upright. Keep one hand holding the top half circle so that it does not fall until fully installed. Turn the top half circle to engage the thread on the half circle into the connector in the upright until the top circle is fully secured and not wobbling before letting go of the top half circle. If the top half circle isn't secure it can pose a risk of falling, make sure it's secure.
3. Place your graphic into the recessed slot of the top half circle, making sure to align the top of the graphic vertically (if applicable).

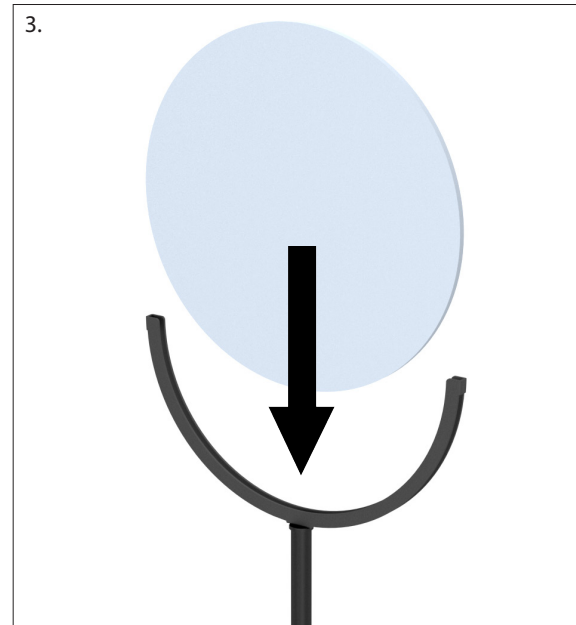
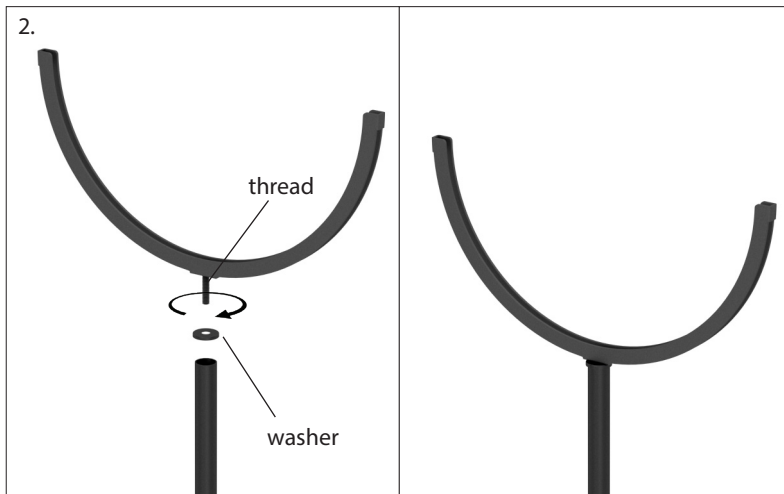
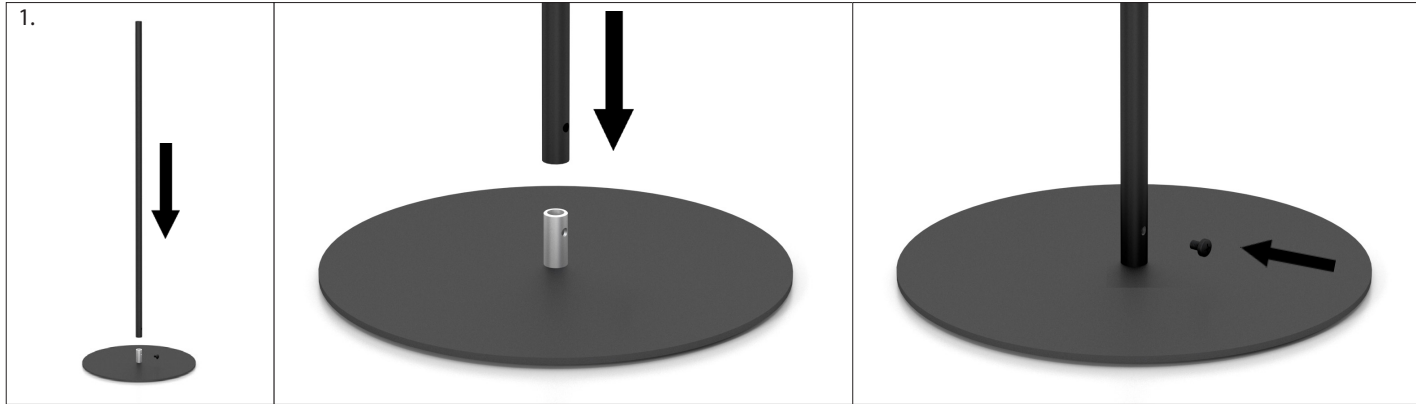

LOLPOP13H-B shown